



MONSTER CLAMP BIPOD

ADJUSTABLE BARREL MOUNT
FITS .43" - .75" BARRELS

OWNER'S MANUAL

For Models: •TL-BP08S-A •TL-BP18S-A •TL-BP08ST-A

MUB020021508

NOTE: Illustrations in this manual use a bipod with rubberized feet. Unless otherwise shown, same instructions apply to the steel feet model.



Release Lever

Re-enforced Steel Barrel Clamp, Quick Release Lever and Adjustment Wheel



Posi-lock Leg Control to Prevent Tipping

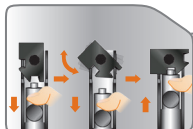

Innovative Folding and Un-folding Mechanism with Positive Locking



Heavy Duty Non-Slip Rubberized Foot Pads (or Durable Steel Feet)



Open Angle 50°

Center Height



Heavy Duty Mounting Base



Durable Rubber Tape for Barrel Protection



Sturdy Foldable Legs



Extendable Legs with Spring Loaded Extension



Reversible

Rugged Steel Stands for Stable Support on Any Shooting Surface, Feet Direction Reversible for Desired Leg Folding Direction

Model	Stand Type	Compatible Barrel Diameter	Extendable Legs	Open Angle	Center Height (Min - Max)	Leg Length (Min - Max)
TL-BP08S-A	Rubberized	0.43"-0.75"	Yes	50°	9.0"-11.0"	9.5"-11.5"
TL-BP18S-A					6.2"-6.7"	6.7"-7.5"
TL-BP08ST-A	Steel				8.7"-10.2"	7.8"-10.3"

BARREL CLAMP INSTALLATION STEPS



Press the barrel clamp Release Lever down to open the barrel clamp.



Place the rifle barrel in the center of the clamp, hold down the Release Lever, close the barrel clamp over the barrel and release the lever to lock the barrel in place.



Turn the adjustment wheel clockwise to secure the barrel inside the bipod clamp. Additional torque can be applied for a tighter fit by using a small Allen Wrench with the adjustment wheel.



To uninstall the bipod, reverse the actions from Step 3 to 1.

CAUTION: Do not exceed 35 in/lb of torque when turning the adjustment wheel to avoid product damage.

LEG FOLDING/UN-FOLDING INSTRUCTION



Press down and hold the posi-lock button.



Fold the bipod leg forward and release the posi-lock to secure hold in position. To un-fold, press down on the posi-lock and reverse the leg direction.



LEG EXTENSION/RETRACTION INSTRUCTION



Turn the collar as shown to release or to lock the bipod extension leg.



Bipod leg extension is spring loaded, extendable to any desired position. To lock into a position, tighten the collar in the locking direction.



To retract the bipod leg, release the collar and push the extension leg back into the leg housing and then lock the collar.



NOTE: During leg extension, be cautious and clear the space to allow the spring force to push the leg out. Stop loosening the collar when the leg is extended. If over-loosening the collar, the leg will be disassembled and the inner spring will fall out. Simply re-insert the spring to re-assemble the leg extension.