



TACTICAL OP BIPOD

PICATINNY & SWIVEL STUD MOUNT

OWNER'S MANUAL

For Models: • TL-BP78Q • TL-BP88Q

MUB007021307

FEATURE ILLUSTRATION

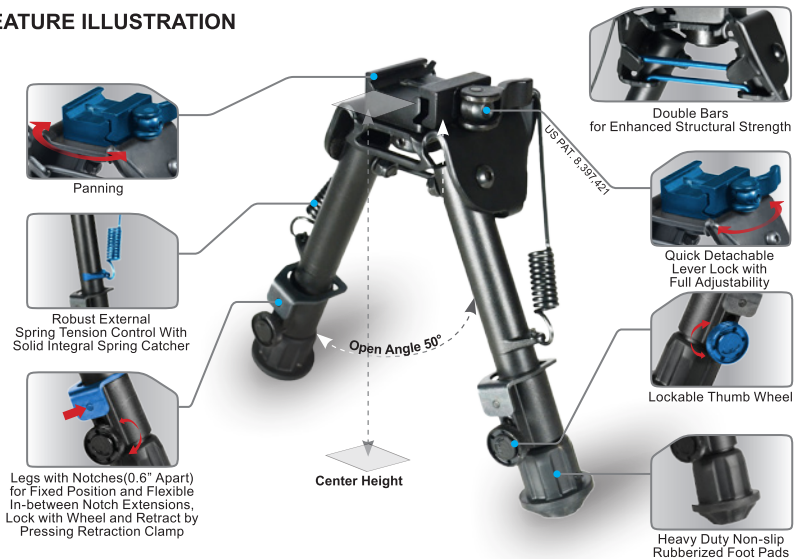

Model	Stand Type	Center Height (Min - Max)	Leg Length (Min - Max)	Extendable Leg	Open Angle	Picatinny Mount	Swivel Stud Mount
TL-BP78Q	Rubberized	5.9"-7.3"	5.5"-7.4"	Yes (3 Notches)	50°	Yes	Yes
TL-BP88Q	Rubberized	8.0"-12.4"	7.7"-12.7"	Yes (7 Notches)	50°	Yes	Yes



SWIVEL STUD MOUNT



PICATINNY MOUNT

PICATINNY MOUNT INSTALLATION



Turn the cam lever to its unlocked position. Place the bipod on the rail at a desired position.



Turn the cam lever half way to the locking position. Use step 3 to complete proper adjustment.



Use the included Allen wrench to adjust the hex screw at the side of the cam for proper tension and fit against the rail. Adjust clockwise to increase the tension and tighten the clamping width. Adjust counter-clockwise to decrease the tension and increase the clamping width.



Once you achieve the optimal tension, push the Cam Lever all the way to the left for a positive lock onto the rail. You may repeat Step 3 and 4 to find the best clamping tension and locking position.

SWIVEL STUD MOUNT INSTALLATION

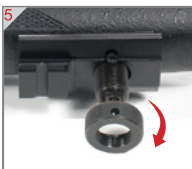
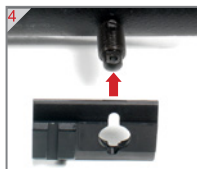
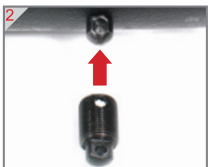
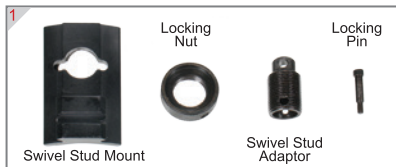

Refer to the **PICATINNY MOUNT INSTALLATION** to install the bipod on the rail provided on the Swivel Stud Mount.

FOLDING OPERATING INSTRUCTION



Hold the bipod Leg.



Fold the bipod leg forward with Lockable Thumb Wheel facing up and release when the leg is in position. Reverse direction to un-fold.



LEG EXTENSION/RETRACTION INSTRUCTION



Make sure the Posi-lock Wheel is fully released by turning it counter-clockwise.



Extend the bipod leg by pulling it out of leg housing. Set it at any of the pre-cut extension notches for a positive position.



Or, extend to any location in between notches. When satisfied with the length, Lock the extended leg by tightening the Posi-lock Wheel clockwise.



To retract the bipod leg, loosen the Posi-lock Wheel first. Press down the Leg Retraction Clamp before you push the extended leg upward into the housing.