

LED FLASHLIGHT

U n l e a s h T h e G l o w



VANQUISH

LED FLASHLIGHT

U n l e a s h T h e G l o w

OWNER'S MANUAL

For Model: LT-SEL555



CAUTION!

If you need to mount the flashlight onto a firearm, make sure firearm is not loaded before installation. Remove magazine and examine chamber. Use safe handling procedures at all times.

Light produces substantial heat during operation. Do not leave activated flashlight unattended. Do not set activated flashlight face down. Do not place activated flashlight against combustible material or material that could be damaged by heat. Do not hold bezel or lens of activated flashlight against any portion of human body. Keep away from children.

Ensure that the flashlight cannot be turned on when stored or being transported. If the lamp is activated while in a case or any container, the lamp could overheat and cause damage to surrounding materials.

Do not touch a hot lamp assembly. Allow it to cool before handling. Avoid touching reflector surface. Always wear safety glasses when handling the lamp assembly.

Turn off the light when not in use to conserve battery power.

Keep the battery cool and dry. Always disconnect battery from light after use. Leaving battery attached to the light without use for long period of time may cause damage or danger.

Never deliberately short circuit batteries. Prolonged short circuit will cause the battery to lose energy and result in significant temperature increase.

Lithium batteries can explode or cause burns if disassembled, shorted, exposed to water, fire, or high temperatures. Do not store battery pack with hazardous or combustible materials. Store in cool, dry, ventilated area. Follow applicable laws and regulations for disposal.

LT-SEL555 comes with a proprietary battery and charger. Do not use any other brand of charger or battery as this could lead to damage and will void warranty.

Do not attempt to lubricate any part of the flashlight.

Component Illustration

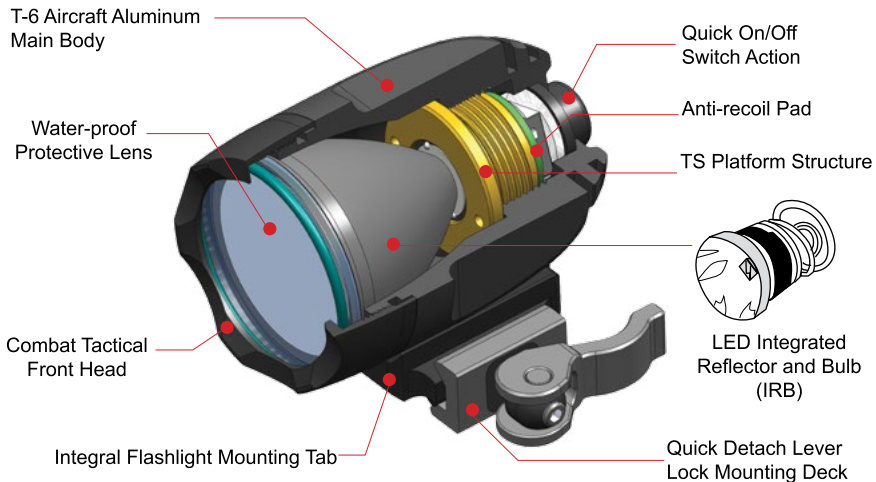

The purpose of this diagram is to provide a better understanding of the superior internal structure of the flashlight. Please do NOT disassemble the product which will void its warranty.

LT-SEL555 Specifications						
Light Bulb	Voltage	Main Body Diameter	Weight with Battery	Mounts	Focus	Pressure Switch
T6 40mm LED IRB	9.6V	1.88"	960g (5.6oz)	QD Weapon Mount/Bike Mount/Hand Grip	Preset	N/A
Length	Max. Output		Medium Output		Low Output	
	Lumens	Battery Operating Time	Lumens	Battery Operating Time	Lumens	Battery Operating Time
2.8"	530	4hrs+	240	10hrs+	120	20hrs+

Battery Specification: External 9.6V Long Lasting Rechargeable Lithium Iron Phosphate Battery with Built-in Safety Shut-off Feature, Protected with Weather-proof Polymer Case, Including Heavy Duty Water-proof Coil Cord with Locking Connectors for Charger Attachment.

LT-SEL555 uses an Integral Mounting Tab and 3mm Hex screws to attach the light's main body to the QD Mounting Base, the Grip Mount or the Bicycle Bracket.



LT-SEL555 Product Contents

			
1) Main Body with Power Cord	2) Bicycle Bracket with Rubber Spacers	3) 110 Volt AC/DC Charger	4) International Power Adapter
			
5) Grip Mount	6) Picatinny QD Mounting Base, Screws and Washers	7) Rechargeable Battery	8) 1 X 3.0mm Allen Wrench 1 X 2.5mm Allen Wrench 1 X Spare Screw 1 X Washer

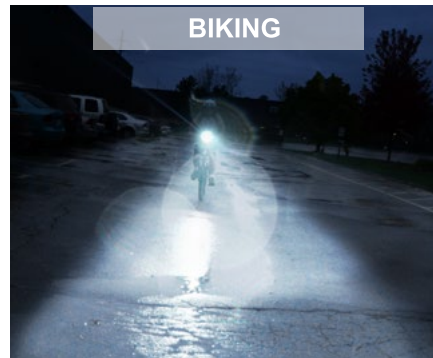
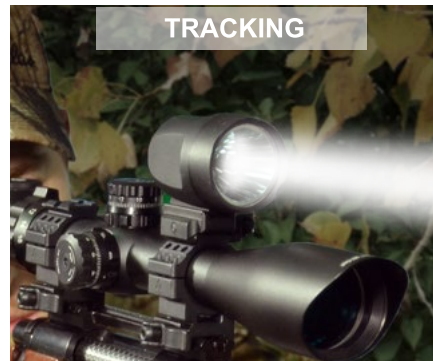

A. Mounting Application

NOTE: LT-SEL555 comes pre-installed on the QD Mounting Base.



I. Mounting on Picatinny Rail



I-1. Turn the Cam Lever to its un-locked position. Place the QD Mounting Base on the Picatinny rail at a desired position. Turn the Cam Lever half way toward the locking position. Use I-2 and I-3 to complete proper adjustment.



I-2. Use the 2.5mm Allen Wrench to adjust the Hex Screw at the side of the cam for proper tension and fit against the rail. Adjust clockwise to increase the tension and reduce the clamping width. Adjust counter-clockwise to decrease the tension and increase the clamping width.

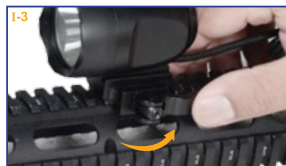

I-3. The optimal tension is achieved when the side plate first makes contact with the rail while the Cam Lever still has enough travel left for you to securely snap into its locking position. Once you achieve the optimal tension, push the Cam Lever all the way to the right for a positive lock onto the rail. You repeat I-2 and I-3 if needed to find the best clamping tension and locking position for your QD Mounting Base on the rail.

II. Securing the Battery



II-1. A butt stock sling adapter, such as UTG's PVC-GB501, is recommended to secure the battery.



II-2. Use the Button Strap on the battery pouch to secure the battery to your sling adapter.



II-3. Select one of the two buttons to snap the Battery Strap securely in place.



II-4. Secure excess wiring on pouch or butt stock to avoid interference while shooting.

III. Removing the QD Mounting Base



III-1. Use the 3mm Allen Wrench to remove the 2 Hex Screws/Washers from the QD Mounting Base. Make sure to retain the Hex Screws/Washers for other applications.



III-2. Detach the QD Mounting Base by pulling it away from the Integral Mounting Tab on the light.



III-3. The Main Body can now be used with the grip mount for handheld application or with the Bicycle Bracket for biking.

9 B. Handheld Application

NOTE: Refer to A.III to remove the QD Mounting Base, if needed, before installing the Grip Mount.



1. Pull and remove the rubber end cap from the Grip Mount.



2. Insert the 2 Hex Screws/Washers into the 2 screw holes inside the Grip Mount.



3. With finger grooves facing the light reflector, fit the screws in the grip into the 2 holes on the flashlight's Integral Mounting Tab.

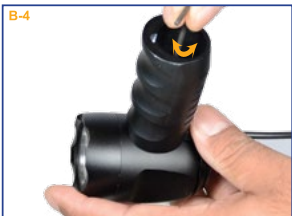

4. Use the 30mm Allen Wrench to tighten the screws and secure the Grip Mount to the flashlight.



5. Reinstall rubber cap by aligning the anti-rotation tab with the corresponding slot on the grip and pressing the cap in firmly.



6. Refer to Operation on page 12 to connect your battery.

10 C. Bicycle Application

NOTE: If needed, refer to A.III to remove the QD Mounting Base, or refer to B-1 to B-5 in reverse order to remove the Grip Mount.



1. Seat the Integral Mounting Tab of the light into the top recess on the Bicycle Bracket.



2. Insert the 2 Hex Screws/Washers from the bottom side of the bracket into the screw holes of the Integral Mounting Tab. Tighten the screws to install the light securely on the Bicycle Bracket. Remove the thumb screw and detach the lever lock screw from the Bicycle Bracket.



3. Put the 2 Rubber Spacers against the inner surface of the bracket halves. Use standard household tape to protect your handlebar from scratches if not using Rubber Spacers.



4. With the UTG logo facing up and the clamp opening pointing to the bicyclist, clamp the bracket on the handle bar of the bike.



5. Insert the lever lock screw back through the clamp. Replace the thumb screw and properly fit its slotted surface against the raised bar in the bottom bracket.



6. While holding the thumb screw steady, raise the lever up and turn clockwise to tighten the clamp on the handle bar. When you feel the bracket has a secure grab on the handle bar, lock down the lever.

In a secured installation, the bracket should be immobile on the handle bar and the lock lever should not move on the bracket. Use the above process for adjustment if you need to change the position of the bracket or adjust the angle of the light beam. Attach and properly secure the battery to a safe location on the bicycle. Ensure the cord will not tangle in the pedals or impede steering.

11 Battery Charging

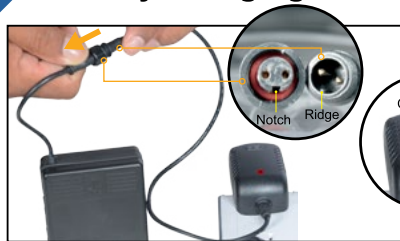

1. Connect the battery charger to the battery pack by joining the pignose adaptors. Align the ridge at the end of the charger cord with the notch at the end of the battery cord to connect properly.

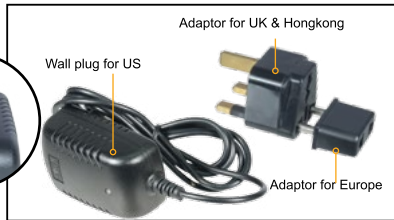

2. Choose a proper plug adaptor for your location before plugging the charger into an electrical outlet. Charging is in process when the light is red on the charger and it will turn green when charging is complete.

Operation

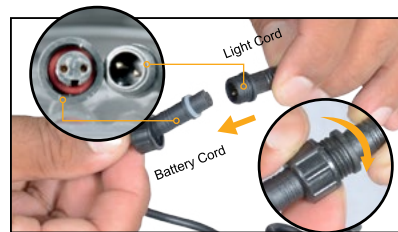

1. Connect the battery pack to the flashlight by joining the pignose adaptors. Align the ridge at the end of the light cord with the notch at the end of the battery cord to connect properly.



2. Use the rubber button on the light to turn on/off or to rotate through any of the 5 functions. Below are details on how to use the rubber button:

- On/off function - Press the button for an audible click.
- Five lighting functions including 3 brightness levels, strobe and SOS –
 - When light is on, soft touch the rubber button (no clicking sound) when the light is on to rotate to the next function.
 - Or, click-press the button within 2 seconds of turning the light off can also be used to rotate to the next light function.
- The light has a memory feature and will light up at the last function used for more than 3 seconds.

Maintenance

- Store the flashlight in a cool dry place when not in use. Be careful to avoid contact with acid, alkaline or corrosive chemicals.
- Maintain the metal surface of the flashlight by removing any dirt or sand with a soft brush to avoid scratching the finish.
- Disconnect the flashlight from the battery pack when not in use.
- Integrated Reflector & Bulb (IRB) Replacement
 - Make sure the battery is disconnected from the light. Unscrew the Front Head by turning it counterclockwise to expose the bulb.
 - Pull out the IRB from the Flashlight Head.
 - Place new IRB in flashlight body and screw Front Head back in to complete the replacement installation.
 - IRBs are available for sale through Leapers/UTG distributors/dealers.



The Best Never Rest Warranty - Lifetime

Leapers, Inc. warrants that all UTG & UTG PRO products conform to published specifications and are free from defects in material and workmanship. We will repair or replace defective products for the duration of the product's life span. Our dedicated and professional in-house customer service team will go above and beyond to make things right and provide the best in-class customer service experience you expect to receive.

Our warranty does not extend to products damaged from misuse, accidental damage, negligence, natural disasters/accidents, or unauthorized repair or alteration.

For warranty service, please submit your inquiry by visiting our customer service page on our website at www.leapers.com or give us a call at 734-542-1500. A Return Authorization Number (RMA) must be assigned before returning any products for warranty service.

Disclaimer and Limitation of Liability

Leapers is pleased to offer suggestions of the use of its products, however Leapers neither assumes responsibility for any omissions or errors nor assumes liability for any damages that result from the use of its products in accordance with information provided by Leapers, whether verbal or written.

EXCEPT FOR THE EXPRESS WRITTEN WARRANTY SPECIFICALLY SET FORTH ABOVE, ALL EXPRESS AND IMPLIED REPRESENTATIONS AND WARRANTIES ARE HEREBY DISCLAIMED, INCLUDING ANY IMPLIED WARRANTY OF MERCHANTABILITY, NON-INTERFERENCE, FITNESS FOR A PARTICULAR PURPOSE, NON-INFRINGEMENT, OR WARRANTY OF ACCURACY OF ANY INFORMATION PROVIDED WHETHER WRITTEN OR ORAL. ALL WARRANTIES ARISING FROM ANY COURSE OF DEALING, LAW, USAGE OR TRADE PRACTICE ARE HEREBY EXPRESSLY EXCLUDED TO THE EXTENT ALLOWED BY LAW. TO THE EXTENT AN IMPLIED WARRANTY CANNOT BE EXCLUDED, SUCH WARRANTY IS LIMITED IN DURATION TO ONE YEAR. SOME STATES OR JURISDICTIONS DO NOT ALLOW LIMITATIONS ON HOW LONG AN IMPLIED WARRANTY LASTS, SO THE ABOVE LIMITATION MAY NOT APPLY TO YOU.

UNDER NO CIRCUMSTANCES IS LEAPERS, OR ITS SUPPLIERS OR RESELLERS LIABLE FOR ANY OF THE FOLLOWING EVEN IF INFORMED OF THEIR POSSIBILITY: 1) THIRD PARTY CLAIMS AGAINST YOU FOR DAMAGES; 2) SPECIAL, INCIDENTAL, OR INDIRECT DAMAGES OR FOR ANY ECONOMIC CONSEQUENTIAL DAMAGES; OR 3) LOST PROFITS, BUSINESS REVENUE, GOODWILL, OR ANTICIPATED SAVINGS. SOME STATES OR JURISDICTIONS DO NOT ALLOW THE EXCLUSION OR LIMITATION OF INCIDENTAL OR CONSEQUENTIAL DAMAGES, SO THE ABOVE LIMITATION OR EXCLUSION MAY NOT APPLY TO YOU.