



AR15

SUPER SLIM **DROP-IN** RAIL SYSTEM

Fits Carbine Length AR15 Equipped with Delta Ring Assembly
& Round Front Handguard Cap



AR15

SUPER SLIM **DROP-IN** RAIL SYSTEM

Fits Carbine Length AR15 Equipped with Delta Ring Assembly
& Round Front Handguard Cap

Made in USA

UTG INNOVATIVE SUPER SLIM DROP-IN DESIGN



Detachable
Keymod Compatible
Rail Section

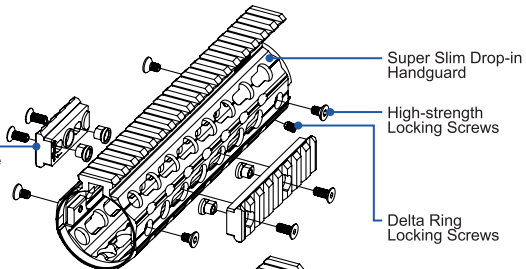

Super Slim Drop-in
Handguard

High-strength
Locking Screws

Delta Ring
Locking Screws



Detachable M-LOK™
Rail Section

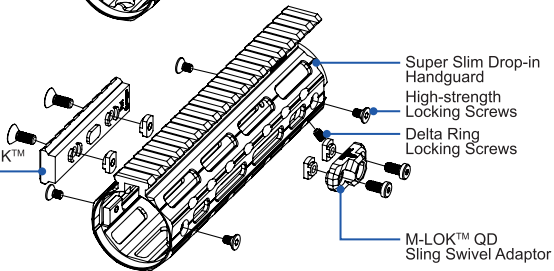

Super Slim Drop-in
Handguard

High-strength
Locking Screws

Delta Ring
Locking Screws

M-LOK™ QD
Sling Swivel Adaptor



	KEYMOD		M-LOK	
Item # (Model)	MTU001SSK	MTU015SSK	MTU001SSM	MTU015SSM
Length	7"	15"	7"	15"
Installation Locking Screw	√	√	√	√
1/8" Allen Wrench	X	X	√	√
3/32" Allen Wrench	√	√	√	√
2mm Allen Wrench	√	√	√	√
3mm Allen Wrench	√	√	√	√
4-Slot Rail Section	√	√	X	X
8-Slot Rail Section	√	√	√	√
QD Sling Swivel Adaptor	X	X	√	√

Caution: Make sure firearm is not loaded. Remove magazine and examine chamber. Use safe handling procedures at all times.



Remove the stock handguard by completely depressing the Delta Ring in order to remove both the top and bottom pieces of the handguard. Using a handguard removal tool is recommended for the installation of this product.



Place the Top Rail Cover over the barrel, making sure the non-tapered end of the cover is facing towards the muzzle. Seat the tapered rear of the Top Rail Cover so that it will slip underneath the Delta Ring. Do this by completely depressing the Delta Ring and indexing the Top Rail Cover Spinal Cords with the two corresponding barrel nut grooves found on the left and right side of the Gas Tube.

Note: Although unlikely, if the Top Rail Cover does not align correctly with the upper receiver after installation, slight adjustments to the barrel nut alignment may be required.



Next, carefully index the non-tapered end of the cover so that it seats on top of the Round Handguard Cap. Pressing the non-tapered end down onto the Round Handguard Cap may be required. Once seated, release the Delta Ring. It should overlap the rear of the Top Rail Cover.

For 15" Rails Only:

The Fixed Front Sight passes through the Top Rail Cover cutout and the Round Handguard Cap is enclosed and seats into an inner cutout underneath the Top Rail Cover. Pushing the Round Handguard Cap down into this inner cutout may be required.



Place the Bottom Rail Cover underneath the barrel, making sure the non-tapered end of the cover is facing towards the muzzle. Seat the tapered rear of the Bottom Rail Cover so that it will slip underneath the Delta Ring by first pushing back on the Delta Ring with it. With the Delta Ring depressed, index the Bottom Rail Cover Spinal Cord with the corresponding Barrel Nut Groove. Next, carefully index the non-tapered end of the cover so that it seats over the Round Handguard Cap. Pressing the non-tapered end up onto the Round Handguard Cap may be required. Once seated, release the Delta Ring. It should now overlap the tapered rear of both the top and bottom rail covers.

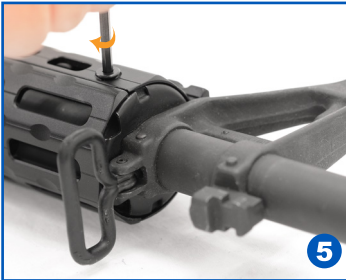

Secure the two rail covers together by using the supplied 3mm Allen Wrench to screw in the four M4 Locking Screws. There are two screw holes on each side of the handguard. Turn the Allen Wrench clockwise to tighten. Recommended torque value: 15 in-lbs.



Using the supplied 2mm Allen Wrench, screw the two M4 Delta Ring Locking Screws into the screw holes found on the Bottom Rail Cover towards the rear. Recommended torque value: 10 in-lbs.

Note: NEVER use power tools for any fastener installation. Always hand-tighten screws with appropriate Allen Wrenches included with the product. Do not over tighten any screw. If desired, apply a small amount of locking compound to the threads prior to tightening.

The Following Instructions are for the 15" Extended Rail System Only



To install the Extended Bottom Rail Cover, place the cover underneath the Extended Top Rail Cover with the bayonet cutout towards the rear. Align the top and bottom rail cover screw holes. Secure the two rail covers together by using the supplied 3mm Allen Wrench to screw in the four M4 Locking Screws. There are two screw holes on each side of the extended rail cover. Turn the Allen Wrench clockwise to tighten. Recommended torque value: 15 in-lbs.

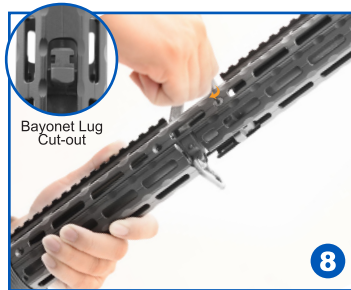

ATTACHING KEYMOD COMPATIBLE PICATINNY RAIL SECTION

To install your detachable Keymod Compatible Picatinny Rail Section or other Keymod Compatible accessories, please refer to the following steps.

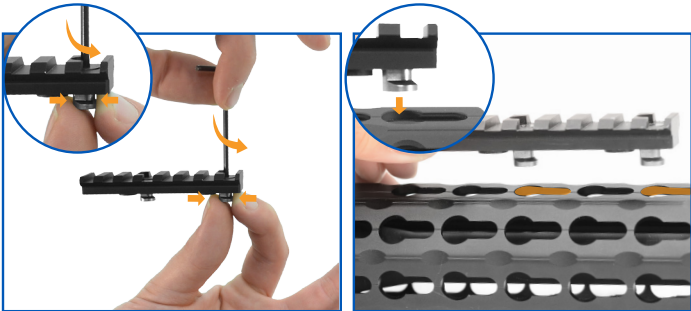

Hold the Keymod Nut in place and loosen the screw by turning it counter-clockwise with the included 3/32" Allen Wrench. Do not fully detach the Keymod Screw from the Keymod Nut.

Place the rail with the Keymod Nuts onto the desired slots of the handguard rail, inserting the nuts through the larger opening of the Keymod Slots with the protruding feet of the nuts pointing toward the muzzle of the firearm.

Note: The Keymod Nut and Screw can be fully disassembled if needed.

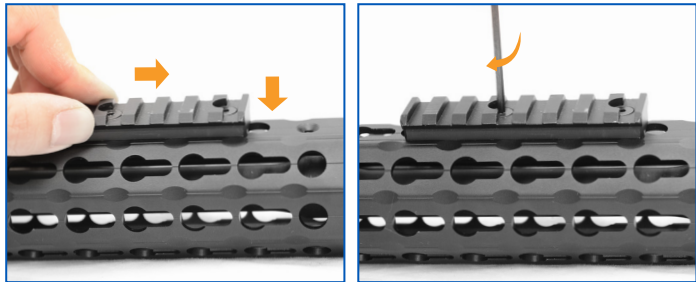

Once the Keymod Nuts are in the slots, carefully slide the Rail Section forward until it fully seats into and engages the handguard, with little to no gap between the Rail Section and the handguard.

Retighten the Keymod Nuts by turning the Allen Wrench clockwise until securely tightened while holding the mounting base in place. Recommended torque value: 15 in-lbs.

ATTACHING M-LOK™ PICATINNY RAIL SECTION

To install your detachable M-LOK™ Picatinny Rail Section or other M-LOK™ accessories, please refer to the following steps.

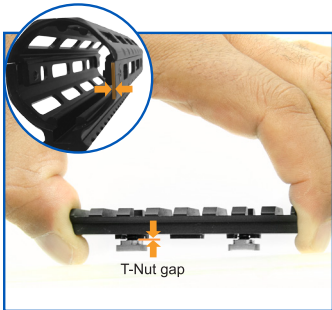

T-Nut gap

In order to properly secure a rail section or other M-LOK™ accessory on your rail system, the T-Nut gap must be slightly larger than the rail thickness. Either measure the rail thickness or use the edge of the rail as a gauge.

Note: The M-LOK™ T-Nut and screw can be fully disassembled if needed.

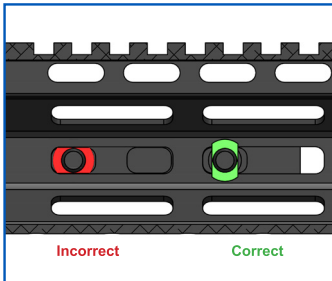

If the T-Nuts are spaced with too much gap they will rotate freely when trying to tighten. Alternately, if the T-Nuts are not spaced with enough gap they will not rotate at all. Observe the T-Nut during the installation process to be certain that they have rotated to their correct position as shown.

Caution: Other accessories (e.g. polymer product) may require different torque values for installation. Refer to manufacturer's operator manual for correct specification.

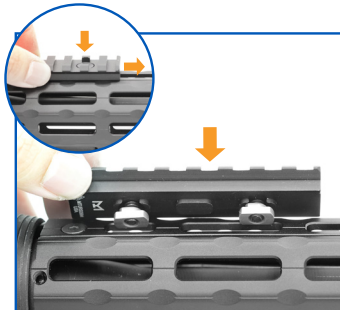

Make sure the rail section/accessory is fully seated and flush on the rail system. "Bias" the rail section by applying pressure downward and towards the muzzle.



Once seated and "biased", hold the mounting base in place and retighten the T-Nuts by turning the Allen Wrench clockwise until securely tightened. Recommended torque value: 35 in-lbs.